

Features

- HDL KNX / EIB multifunction panel controller are in full compliance with European safety standards and the KNX association protocol.
- The touch panels have touch keys and background lights.
- KNX Smart 1, 2, 3, 4 Buttons wall touch switch panel.
- Built-in mini infrared receiver, with the function of sending the variety data points at the same time that can simultaneously control many different types of KNX equipment.
- The simple to use Multi control for:
 - Switch control, Dimming, Scene control, Sequence control,
 - Curtain control, Shutter control,
 - Button Lock, Button Trigger,
 - String control, Flexible control,
 - Percentage control,
 - Combination control, golden metal
- 1 bytes control, 2 bytes control, 4 bytes control bytes (String) control.
- Keep pressing the first and last button together for 2 seconds, the button will flash and database can be downloaded from ETS to the device.

Important Notes

- **Special Programming** – This device is designed for professional KNX installation. It must be programmed by ETS software.
- **Cable Connections** – Do not get wrong connection for Black and Red wires
- **Mounting Location** – When installed outdoors, pay attention to water-proof.
- **Voltage** - The input of voltage must be between 21-30VDC

Installation Steps

- Mount the device inside an approved electrical enclosure.
- Connect KNX /EIB cables. Ensure correct cable type and lengths.
- Re-check all terminations prior to energizing.
- Energize supply and KNX bus. KNX bus shall be between 21-30Vdc.

Product Specifications

- **Working Voltage** : 21-30 V DC
- **Static Current** : <2.0mA
- **Control IO**: KNX TP1 control port
- **User Controls**: Manual Over-ride switch for each button.
- **KNX Terminals**: KNX Bus Terminal – Wago 252 (Red /Black) 0.6-0.8mm Diameter Single Core
- **Compliance**: CE, KNX
- **Construction Dimensions**: 86 x 86 x 10.5 (mm)
- **Housing Material**: glass, PC
- **Working Temperature** : -5°C~45°C
- **Working Relative Humidity** : 10%~98%
- **Storage Temperature** : -40°C~55°C
- **Storage Relative Humidity** : 10%~98%
- **IP class**: IP60



Types

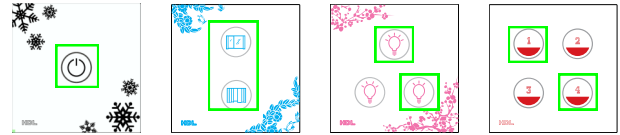

M/TBP1.1 M/TBP2.1 M/TBP3.1 M/TBP4.1

Keep pressing the button for 20S, database can be downloaded from ETS to the panel.

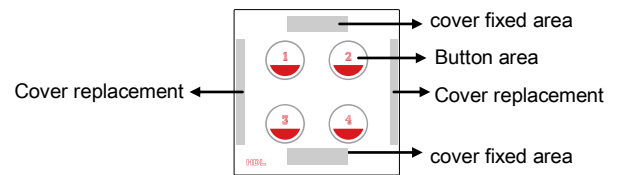
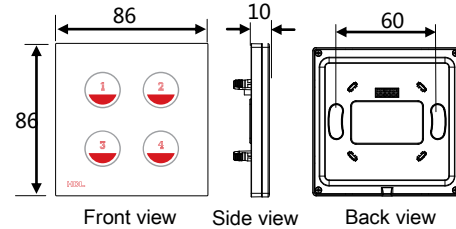

Glass plate replacement: use a small size straight screwdriver insert into the gap of the left side or right side of glass cover (see above cover replacement schematic), to pick up the glass cover, then put the new cover in right place , then press cover fixed area to lock the cover

Installation steps

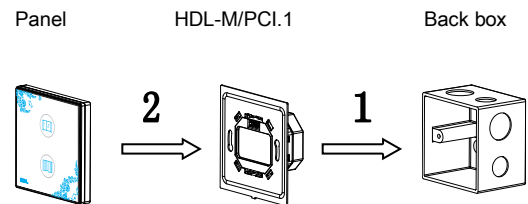

Remove the panel: use a straight screwdriver insert into the “Split fastener” to separate cover and power supply base (M/PCI.1)

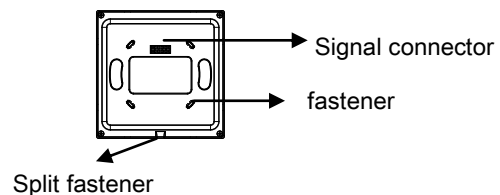

- Screw down strength should not exceed 0.1Nm
- Do not make wrong connection on Bus interface, it will damage the Bus interface this module
- Do not get AC240V voltage into KNX/EIB Bus wire , it will damage all devices in the system
- Ensure good ventilation
- Avoid contact with liquid and aggressive gas